

HEX 8 MM

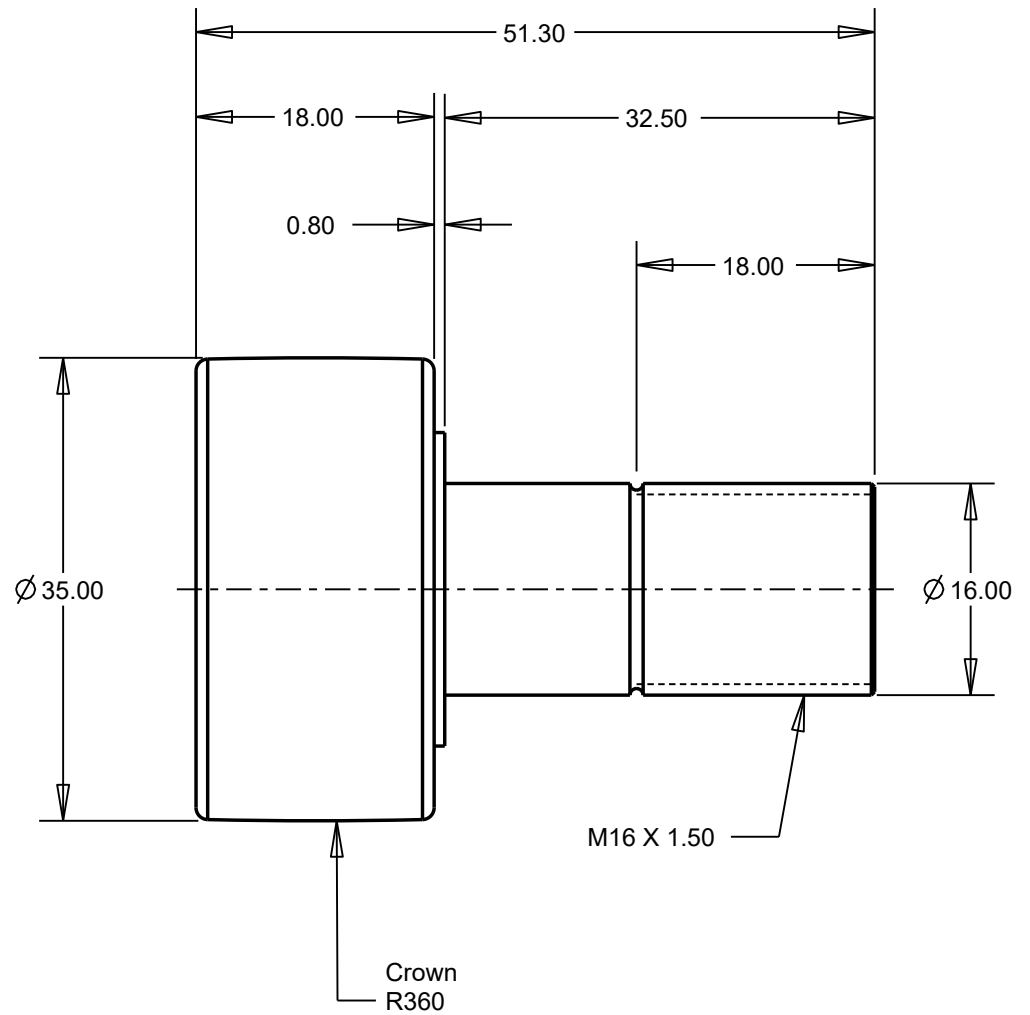

Customer Drawings

REV	DESCRIPTION	DATE	BY	UNLESS OTHERWISE SPECIF. BREAK EDGES .005 X 45° DEBURR AND CLEAN PLASTIC TEETH AFTER MACHINING		ICAM_METRIC_CATALOG_35MM			
-	-	-	-						
CONFIDENTIAL					www.intechpower.com	CAD Model No:		Drawing No:	Rev.
Power-Core™						METRIC DEC .X .20 mm DEC .XX .10 mm DEGREES 1/2	ICAM_METRIC_CATALOG_35MM		ICAM_METRIC_CATALOG_35MM
Drawn by: J.S.		Date: Oct-25-16		Intech PowerCore Corporation 250 Herbert Ave, Closter, NJ 07624 Tel: (201) 767-8066 Fax: (201) 767-7797		Model SCALE: 1.750		SHEET 1 OF 1	